

BEFORE USE:

Please read the instructions carefully. You must inspect the appliance including its cable and plug for any signs of damage. If the product is damaged, DO NOT USE and contact your supplier immediately for refund or replacement.

This product is only suitable for well insulated spaces or occasional use.

MYZEK®

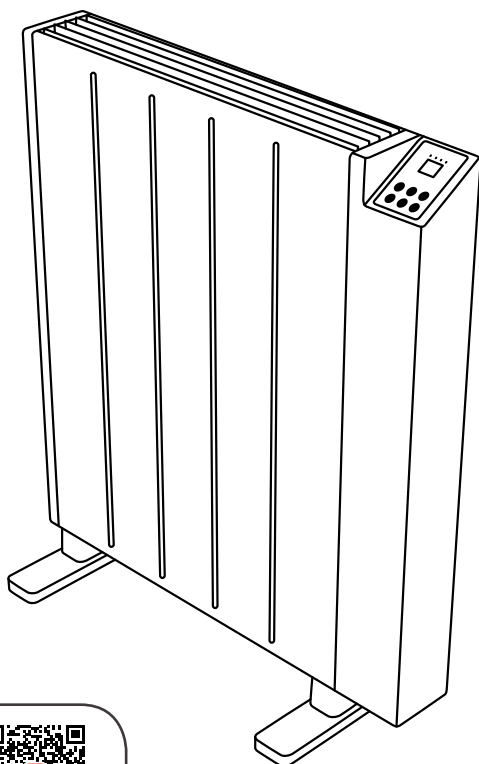

V 2021-06

INSTRUCTION MANUAL FOR MODELS

STEEL HOUSING HEATER

MYSH0406E / MYSH0410E / MYSH0415E / MYSH0420E

| GENERAL INFORMATION

Thank you for choosing the Mylek LED weekly programmable Panel heater with Open window function. Please take time to carefully read and understand the entire instruction manual before using the product and then save it for future reference. We reserve the right for any errors in text or images and any necessary changes made to technical data. If you have any questions concerning operational or technical problems please contact our Customer Services on **0800 091 3171**.

| BEFORE USING THIS HEATER

When using electrical appliances, basic precautions should always be followed to reduce the risk of fire, electric shock, and injury to persons. This includes but is not limited to the following.

CAUTION

This appliance is not intended for use by persons (including children) with reduced physical, sensory or mental capabilities, or lack of experience and knowledge of the product. The appliance is to be operated by responsible adults only after reading and understanding these instructions. Children should be supervised at all times to ensure that they do not play with the appliance. Children under 16 years should not operate the unit or carry out maintenance and/or clean the unit. Any infirmed persons in the vicinity of the unit should be accompanied by a responsible and competent

able bodied adult. Remove the packing and make sure that the appliance is intact. If there is any doubt concerning the integrity of the unit do not use the appliance and contact our recommended after-sales service.

Do not leave any packaging materials within easy reach of children. Before switching on appliance check if the electrical voltage and frequency of the circuit correspond to those indicated on the appliance. Use the appliance only for the stated purpose, namely as a heater for domestic use. Do not use it for any other application as it could be dangerous.

| IMPORTANT SAFETY REQUIREMENTS

- This appliance can be used by children aged from 8 years and above and persons with reduced physical, sensory or mental capabilities or lack of experience and knowledge if they have been given supervision or instruction concerning use of the appliance in a safe way and understand the hazards involved. Children shall not play with the appliance. Cleaning and user maintenance shall not be made by children without supervision.
- Children of less than 3 years should be kept away unless continuously supervised.
- Children aged from 3 years and less than 8 years shall only switch on/off the appliance provided that it has been placed or installed in its intended normal operating position and they have been given supervision or instruction concerning use of the appliance in a safe way and understand the hazards involved. Children aged from 3 years and less than 8 years shall not plug in, regulate

and clean the appliance or perform user maintenance.

- CAUTION - Some parts of this product can become very hot and cause burns. Particular attention has to be given where children and vulnerable people are present.
- If the supply cord is damaged, it must be replaced by the manufacturer, its service agent or similarly qualified persons in order to avoid a hazard.
- CAUTION: In order to avoid a hazard due to inadvertent resetting of the thermal cutout, this appliance must not be supplied through an external switching device, such as a timer, or connected to a circuit that is regularly switched on and off by the utility.
- The heater must not be located immediately below a socket-outlet.
- Means for disconnection having a contact separation in all poles must be incorporated in the fixed wiring in accordance with the wiring rules.
- For correct installation on the wall, thanks to refer to 'Installation on wall' part.
- Fixed heaters are to be installed so that switches and other controls cannot be touched by a person in the bath or shower.
- **WARNING:** The heater must not be used if the glass panels are damaged.



WARNING: In order to avoid overheating, do

not cover the heater.

WARNING: this product should only be installed in Zone 2 and above only if fitted in a bathroom according the national wiring rules.

Note: The drawing below is for reference only.

If this unit is fitted in a bathroom then it should be fitted by a qualified electrician.

In the case as of buildings room, a room receiving a bath or a shower and socket-outlets lower or equal to 32 A the circuit corresponding must be protected by a device with differential residual current (RCD) lower or equal to 30 mA.

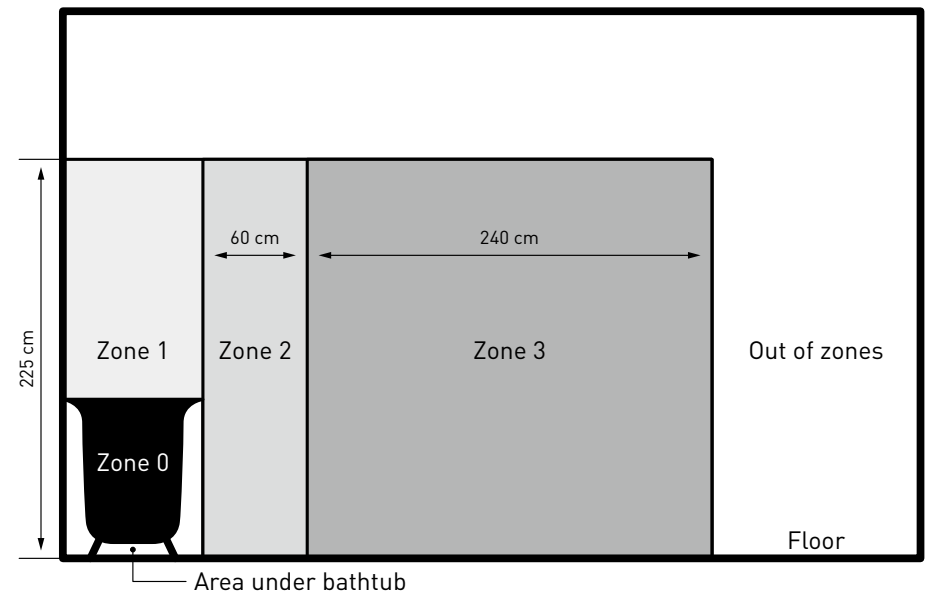

THIS PRODUCT IS FOR ROOM HEATING
FOR HOUSEHOLD USE ONLY

| SPECIFICATIONS

Model No.	FINS	RATED VOLTAGE	RATED POWER
MYSH0406E	4	AC220-240V, 50-60Hz	600W
MYSH0410E	5	AC220-240V, 50-60Hz	1000W
MYSH0415E	7	AC220-240V, 50-60Hz	1500W
MYSH0420E	9	AC220-240V, 50-60Hz	2000W

| STRUCTURE AND PARTS

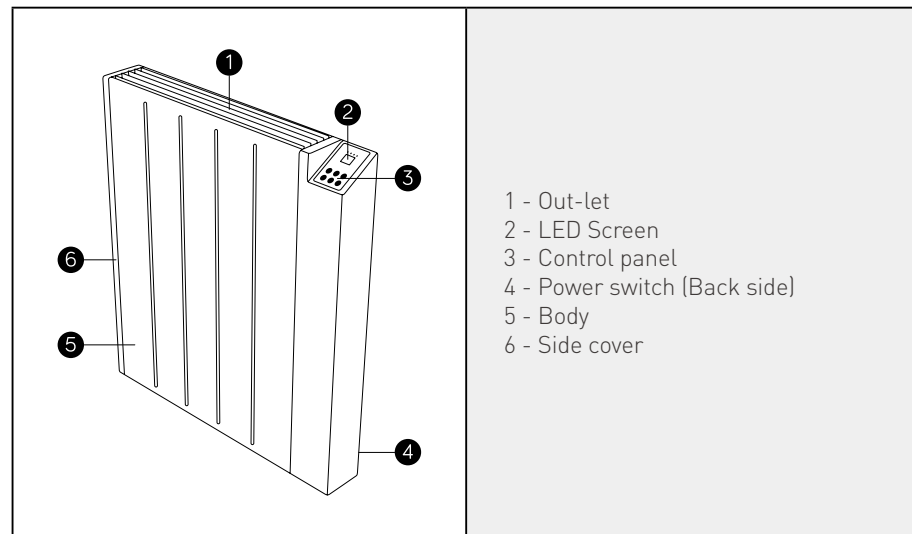

| INSTALLATION ON THE WALL

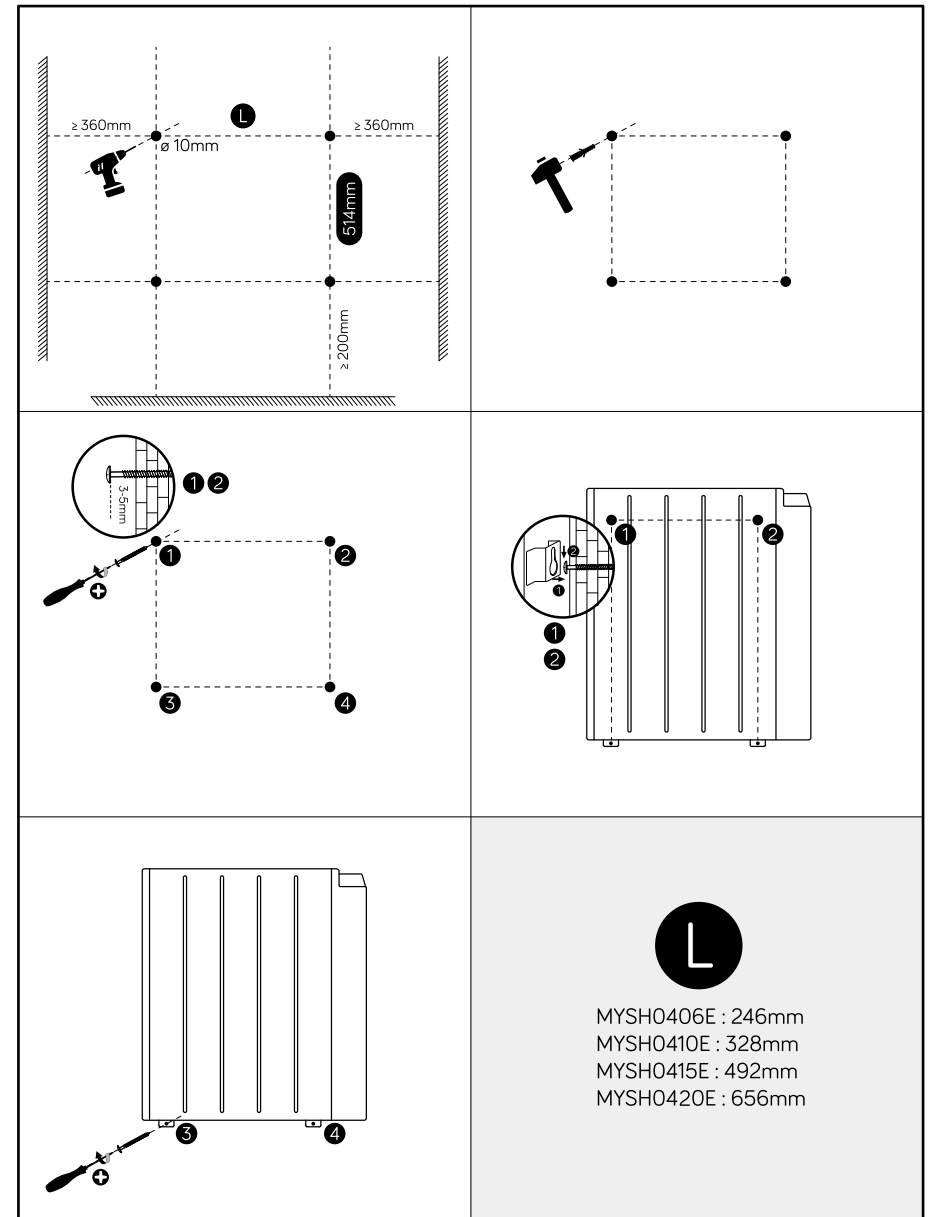

1. Drill holes on the wall according to the above instruction.
Warning: Be sure to keep the safety distances as shown on the above drawing.
2. Fit wall plugs into all 4 holes and fit the screws for 1 & 2 leaving about 3-5 mm protruding to hang the heater.
3. Fix the bracket to the back of the product, hang the unit on the screws gently.
4. Fix the screw for 3 & 4.
Warning: Before using the heater, make sure it's mounted securely on the wall.

To fix the feet, pls see the picture as below:

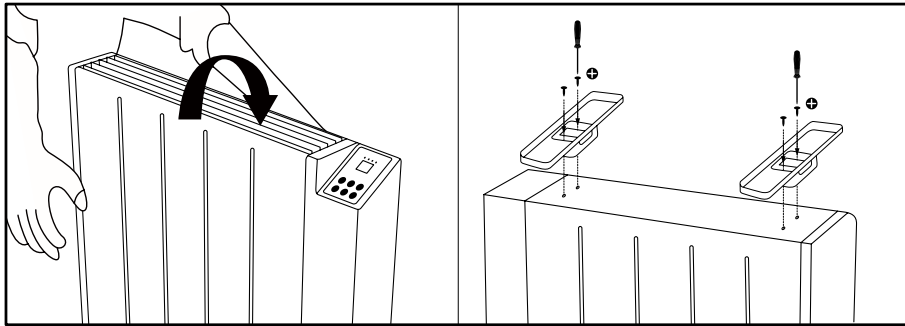

If not use for wall-mounted, pls assembly the feet as above picture.

| CONTROL PANEL AND SCREEN

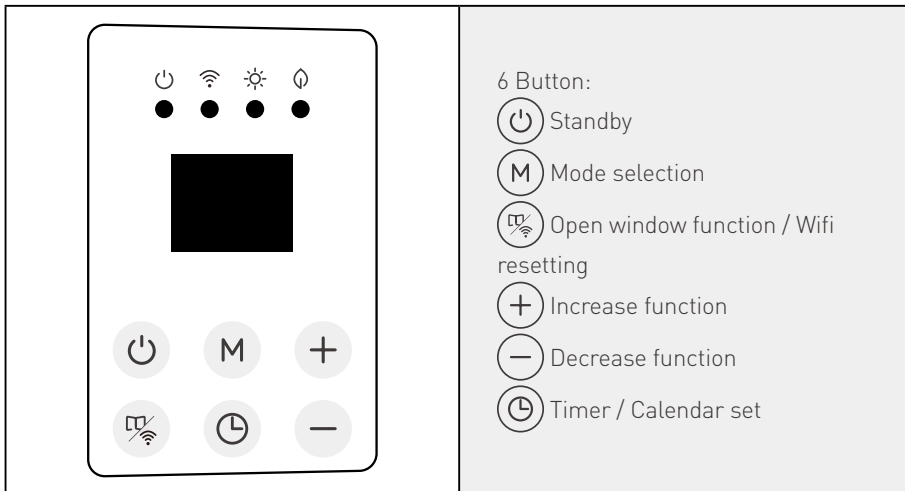

| HOW TO USE

- Plug the appliance to AC 220-240V 50-60Hz socket, the appliance will “beep”, the indicator light is on.
- Press to turn on the heater, which is in factory default settings for first use.
Factory default:
Heating mode: comfort mode.
Target temperature setting: 19°C.
Date: 1(Monday); Time: 00:00 (Off).
Window open function: Off.
Timer: Off
- Press to turn off the heater.
- Unplug the product when it's not in use.

| TIME AND DAY SETTINGS

- Press for 3 secs to enter the current time and day.
- The screen will display “”, press or to select the day from 1-7.

1	Monday	2	Tuesday
3	Wednesday	4	Thursday
5	Friday	6	Saturday
7	Sunday		

- Press to confirm the day setting and will display for the clock on the screen for the hour setting.
- Press and to set the current hour.
- Press to confirm the current hour setting and will display on the screen for the minute setting.
- Press and to set the current minute.
- Press to confirm all settings. The current time and day are now set.

Note: The clock and calendar will be reset to factory default if without power supply

HEATING MODE

- Press **(M)** to enter mode selection. By pressing **(M)**, heating mode runs in a continuous cycle as below:

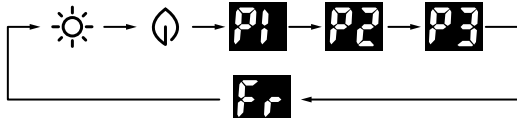

- Comfort mode: Press **(+)** and **(-)** to set the temperature from 5-35 °C.
- ECO mode: Press **(+)** and **(-)** to set the temperature from 1-31 °C.
Note: ECO mode=Comfort mode - 4 °C.
- Anti-frost mode: the screen display . The target temperature is 7 °C. The temperature can't be adjusted.

P1/P2/P3: Pre-set heating program.

(The image below (Figure 1-5) is just for illustration purposes only and not shown on the LED display.)

Note: If the clock and day setting are not finished, the first time to enter P1/P2/P3 program setting, it is requested to set day and clock setting in advance.

P1: (Monday-Sunday) Unadjustable program

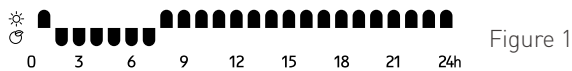

00:00am - 01:00am comfort mode, 01:00am - 07:00am ECO mode and 07:00am - 00:00am comfort mode.

P2: (Monday-Friday) Unadjustable program

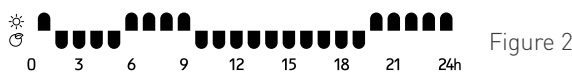

00:00am - 01:00am comfort mode, 01:00am - 05:00am ECO mode 05:00am - 09:00am comfort mode, 09:00am - 19:00pm ECO mode 19:00pm - 00:00am comfort mode

P2: (Saturday-Sunday) Unadjustable program

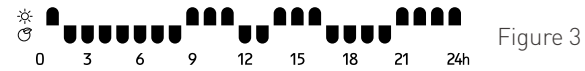

00:00am - 01:00am comfort mode, 01:00am - 08:00am ECO mode
08:00am - 11:00am comfort mode, 11:00am - 13:00pm ECO mode
13:00pm - 16:00pm comfort mode, 16:00pm - 20:00pm ECO mode 20:00pm - 00:00am comfort mode.

P3: (Monday-Friday) Adjustable program

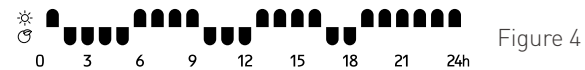

00:00am - 01:00am comfort mode, 01:00am - 05:00am ECO mode 05:00am - 09:00am comfort mode, 09:00am - 12:00pm ECO mode 12:00pm - 16:00pm comfort mode, 16:00pm - 18:00pm ECO mode 18:00pm - 00:00am comfort mode.

P3:(Saturday-Sunday) Adjustable program

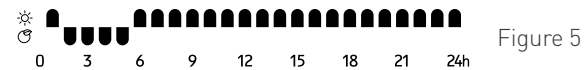

00:00am - 01:00am comfort mode, 01:00am - 05:00am ECO mode 05:00am - 00:00am comfort mode

P3 adjustable program setting

- When under P3 mode, press **(M)** over 3 secs to enter day setting.
- The screen displays , press **(+)** and **(-)** to set from - (Monday-Sunday). Press **(M)** to confirm and enter hour setting
- The screen displays , press **(+)** and **(-)** to set from 00-24). Press **(M)** to choose heating mode for every hour (Comfort mode , ECO mode , show no lights for the unit to operate in anti-frost mode in this hour)

4. Repeat the operation until you have completed the schedule of every hour and every day.

Note: After setting heating mode for hour 23, press (+) to come back to day setting.

Note: when screen displays 17, press (+) finish all setting with display of P3.

| COUNTDOWN TIMER FUNCTION

Press (⌚) one time, the screen display "0H" and keeps flashing. press (+) and (-) to set timer from 0-24 hours. Wait 3 seconds to confirm setting.

| OPEN WINDOW FUNCTION

When the item is heating, the detected room temp drop rapidly over 2 degrees in 2 minutes, open window function would be activated, while the screen would display F0 and flash. The item stops heating.

To turn off open windows function, press (📶) to return the working mode .

Open windows function set: when the item is working, press (📶), will display "F0" or "FF", keep pressing (📶), the open window function will display between "F0" or "FF". "F0" means open window function is on, "FF" means open window function is off.

| WIFI CONNECTION

Use your phone to scan the QR code below or search for the "TUYA SMART" App to download and generate a free account. You can also visit www.tuya.com for more information. Please note Tuya are constantly developing and upgrading their Apps to make them more user friendly and sometimes, displays may differ slightly to the display shown in this manual due to upgrades. If you have any questions concerning technical problems, please contact our Customer Services on **0800 091 3171** quoting the model number found on the unit rating label.



Select your country code, enter your mobile number and select "Get" to receive a message containing your verification code. Enter your verification code and select "Login".

When the first using to turn on the heater, the WiFi indicator light will flash, connect it in the APP.

Reset the WiFi, press (📶) for 3 secs, the item will "beep", the WiFi indicator light will flash rapidly, you can now connect within the APP.

A Quick connection: Turn on your bluetooth in you mobile phone, then set as following steps.



Press "+" in the right-top position and go to next step

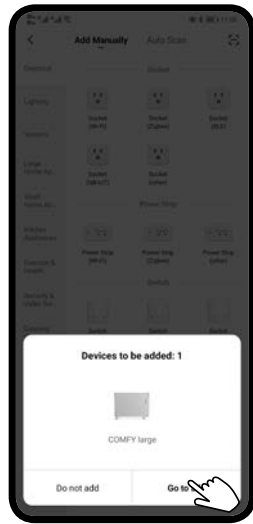

Press "Go to add"

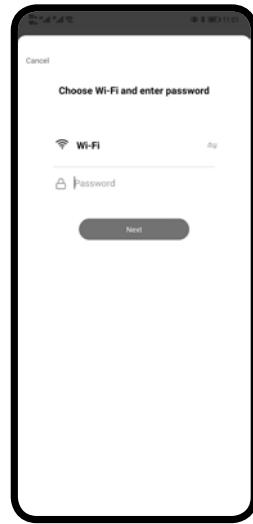

Select 2.4 GHz WiFi Network and enter the password, press next

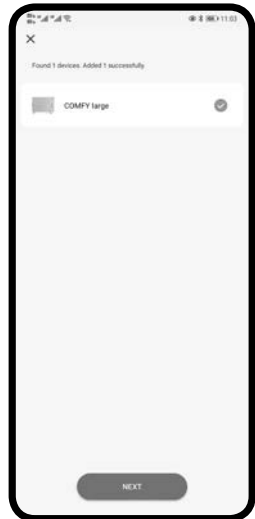

Wait it's connected and press "Next", the APP will show as below

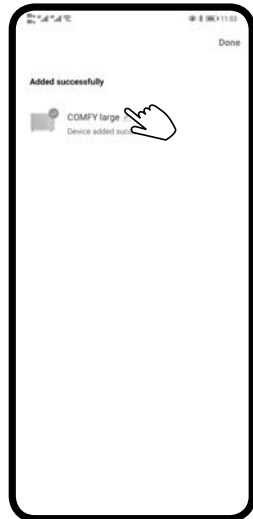

You can press to modify the name of the product

B Normal connection If the bluetooth is not on, pls follow the next step:



Press "+" in the right-top position and go to next step



Choose small home appliance and heater



Select 2.4 GHz WiFi Network and enter the password, press next

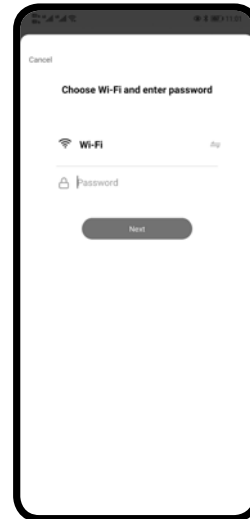

Select 2.4 GHz WiFi Network and enter the password, press next



Wait it's connected and press "Next", the APP will show as below



You can press to modify the name of the product

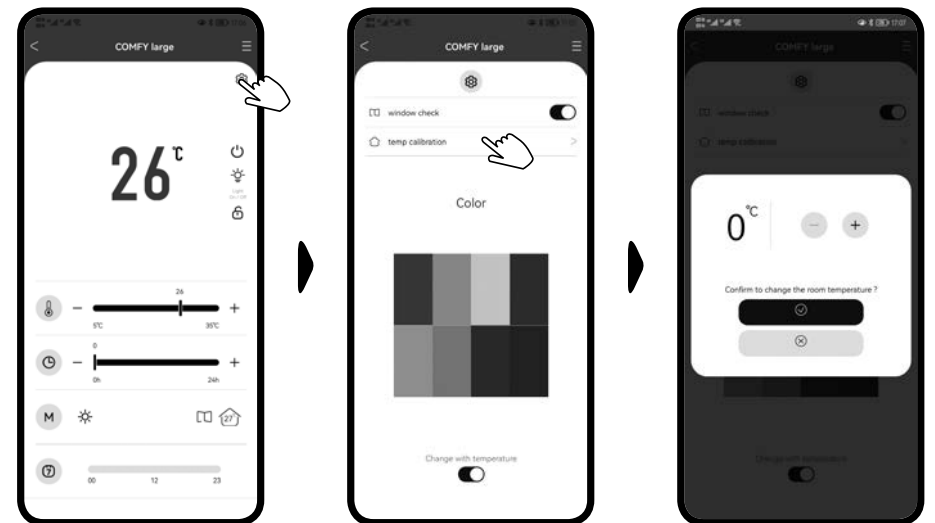
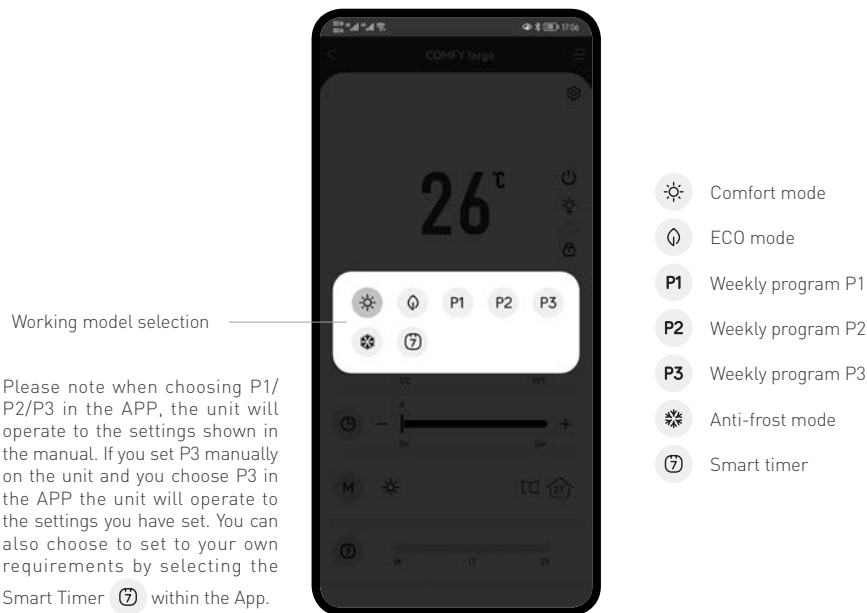
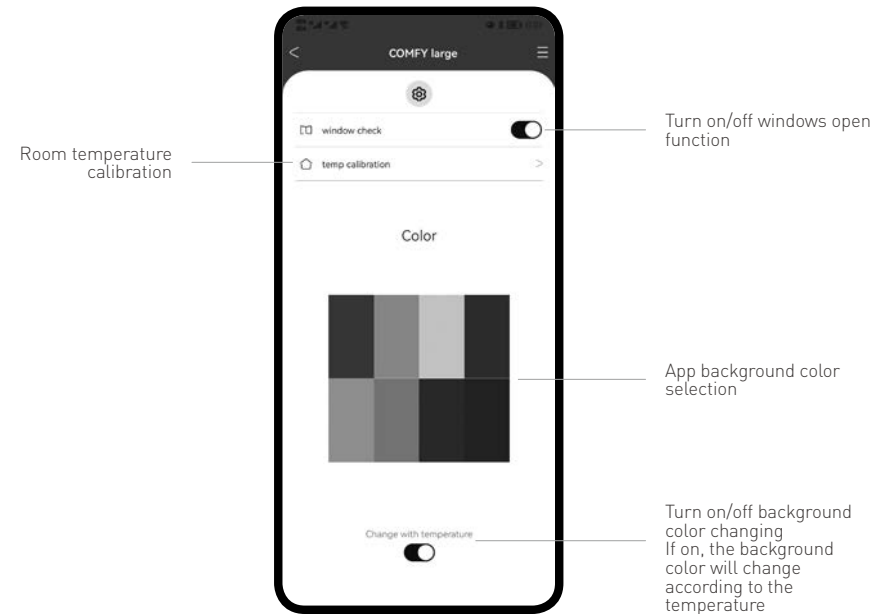
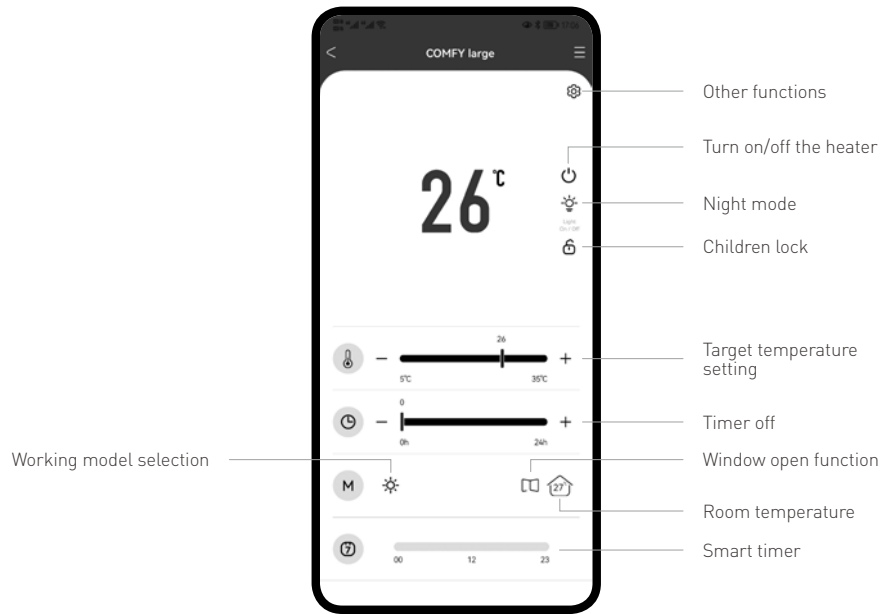

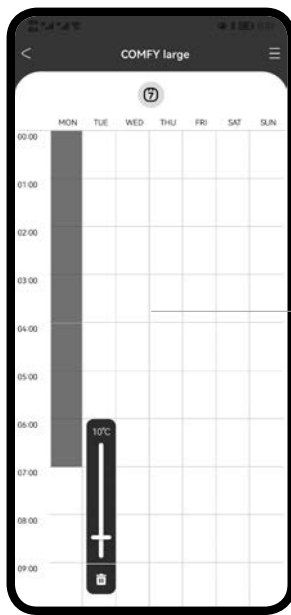

Smart timer:
Set the working time and
working temperature for
every hour in everyday

| MAINTENANCE

1. Always disconnect the appliance and let it completely cool before any maintenance.
2. Use a vacuum cleaner to remove dust on grilles.
3. Clean the outside of the unit with a damp cloth and then dry it with a dry cloth. Never immerse the unit in water, nor let water drip into the unit.

| STORING

1. Always disconnect the appliance, let it completely cool and clean it before storing.
2. If you do not use the device for a long period, put back the unit and the instruction manual to the original carton and store in a dry and ventilated place
3. Do not place any heavy items on top of carton during storing as this may damage the appliance.

Information requirements for electric local space heaters

Model identifier(s): MYSH0406E					
Item	Symbol	Value	Unit	Item	Unit
Heat output				Type of heat input, for electric storage local space heaters only (select one)	
Nominal heat output	P _{nom}	0.6	kW	Manual heat charge control, with integrated thermostat	[no]
Minimum heat output (indicative)	P _{min}	0.6	kW	Manual heat charge control with room and/or outdoor temperature feedback	[no]
Maximum continuous heat output	P _{maxc}	0.6	kW	Electronic heat charge control with room and/or outdoor temperature feedback	[no]
Auxiliary electricity consumption				Fan assisted heat output	
At nominal heat output	eI _{max}	No	kW	Type of heat output/room temperature control (select one)	
At minimum heat output	eI _{min}	No	kW	Single stage heat output and no room temperature control	[no]
In standby mode	eI _{sb}	0.00014	kW	Two or more manual stages, no room temperature control	[no]
Model identifier(s): MYSH0410E				With mechanic thermostat room temperature control	
Item	Symbol	Value	Unit	With electronic room temperature control	
Heat output				Electronic room temperature control plus day timer	
Nominal heat output	P _{nom}	1.0	kW	Electronic room temperature control plus week timer	
Minimum heat output (indicative)	P _{min}	1.0	kW	Other control options (multiple selections possible)	
Maximum continuous heat output	P _{maxc}	1.0	kW	Room temperature control, with presence detection	[no]
Auxiliary electricity consumption				Room temperature control, with open window detection	
At nominal heat output	eI _{max}	No	kW	With distance control option (WiFi Option)	
At minimum heat output	eI _{min}	No	kW	With adaptive start control	
In standby mode	eI _{sb}	0.00014	kW	With working time limitation	
Contact details				With black bulb sensor	
Hygiene Supplies Direct Limited, Ground floor, Tayson House, Methley Road, Castleford WF10 1PA					

Information requirements for electric local space heaters

Model identifier(s): MYSH0415E					
Item	Symbol	Value	Unit	Item	Unit
Heat output				Type of heat input, for electric storage local space heaters only (select one)	
Nominal heat output	P _{nom}	1.5	kW	Manual heat charge control, with integrated thermostat	[no]
Minimum heat output (indicative)	P _{min}	1.5	kW	Manual heat charge control with room and/or outdoor temperature feedback	[no]
Maximum continuous heat output	P _{maxc}	1.5	kW	Electronic heat charge control with room and/or outdoor temperature feedback	[no]
Auxiliary electricity consumption				Fan assisted heat output	
At nominal heat output	eI _{max}	No	kW	Type of heat output/room temperature control (select one)	
At minimum heat output	eI _{min}	No	kW	Single stage heat output and no room temperature control	[no]
In standby mode	eI _{sb}	0.00014	kW	Two or more manual stages, no room temperature control	[no]
Model identifier(s): MYSH0420E				With mechanic thermostat room temperature control	
Item	Symbol	Value	Unit	With electronic room temperature control	
Heat output				Electronic room temperature control plus day timer	
Nominal heat output	P _{nom}	2.0	kW	Electronic room temperature control plus week timer	
Minimum heat output (indicative)	P _{min}	2.0	kW	Other control options (multiple selections possible)	
Maximum continuous heat output	P _{maxc}	2.0	kW	Room temperature control, with presence detection	[no]
Auxiliary electricity consumption				Room temperature control, with open window detection	
At nominal heat output	eI _{max}	No	kW	With distance control option (WiFi Option)	
At minimum heat output	eI _{min}	No	kW	With adaptive start control	
In standby mode	eI _{sb}	0.00014	kW	With working time limitation	
Contact details				With black bulb sensor	
Hygiene Supplies Direct Limited, Ground floor, Tayson House, Methley Road, Castleford WF10 1PA					



This marking indicates that this product should not be disposed with other household wastes throughout the EU. To prevent possible harm to the environment or human health from uncontrolled waste disposal, recycle it responsibly to promote the sustainable reuse of material resources. To return your used device, please use the return and collection systems or contact the retailer where the product was purchased. They can take this product for environmental safe recycling.

The importer retains his right to make changes in appearance and completeness of the item without preliminary notification to the customer.

The item is for indoor use only.

The manufacturer does not assume any liability for any damage caused directly or indirectly by not following this instruction manual, general safety rules, or interference in the construction of the product.

| SERVICE WARRANTY

Hygiene Supplies Direct guarantees the product free from defects in materials and workmanship for a period of 1 year from date of purchase. Should this unit be operated under conditions other than those recommended, at voltages other than the voltage indicated on the unit, or any attempts made to service or modify the unit, then the warranty will be rendered void. The product you buy may sometimes differ slightly from illustrations. This warranty is in addition to, and does not affect, your statutory rights. If you have any problems with this product, please call our Help Desk on **0800 091 3171** or email: **sales@hygienesuppliesdirect.com**

MYLEK[®]

YESSS Electrical, YESSS House, Normanton, WF6 1TN
declares that the Mylek Heaters are exclusively manufactured
and imported for Hygiene Supplies Direct Ltd.